

**NOTES**

1. ALL NEW WORKS AND BUILDING CONTROL TO BE OBTAINED BEFORE WORK COMMENCE.
2. ALL NEW WORKS ARE TO COMPLY FULLY WITH CURRENT BUILDING REGULATIONS.
3. ALL REVISIONS & CHANGES TO BE CHECKED ON SITE BEFORE WORK COMMENCES. ANY DISCREPANCIES TO BE REPORTED IMMEDIATELY.
4. METHODS, MATERIALS SPECIFICATIONS ARE INDICATIVE ONLY. OTHERS MAY BE SUBSTITUTED SUBJECT TO APPROVAL BY THE BUILDING INSPECTOR.
5. THIS DRAWING IS TO BE USED SOLELY FOR THE PURPOSES OF PLANNING AND BUILDING REGULATIONS APPROVAL ONLY.
6. WORK AND NOTES TO COMPLY FULLY WITH THE PROVISIONS OF THE PARTY WALL ACT 1996. CLIENT / HOME OWNER TO BE RESPONSIBLE FOR OBTAINING CONSENTANCE.
7. EXISTING INSULATION FOUNDATIONS - LIKELY TO BE OF A RAFT CONSTRUCTION. IF A RAFT CONSULT WITH STRUCTURAL ENGINEER FOR DESIGN. FOUNDATION DETAILS SUBJECT TO SITE EXCAVATION REVEALING FOUNDATION DETAILS.
8. FOUNDATION DETAILS SUBJECT TO SITE EXCAVATION REVEALING FOUNDATION DETAILS.
9. FOUNDATIONS TAKEN DOWN BELOW FOUNDATION LINE. PROPERLY SHUTTER OUT AND PACK MINIMUM 90mm POLYSTYRENE AROUND PROPOSED FOUNDATIONS FROM EXISTING FOUNDATION LINE. ALL FOUNDATIONS TO BE CONCRETE OR SIMILAR ORIGINAL DISPOSITION IS COMPARABLE WITH PROPOSALS. IF DISCREPANCIES BETWEEN DETAILS / CALCULATIONS MAY BE NECESSARY.
10. FOUNDATIONS TO BE CONCRETE OR SIMILAR ORIGINAL DISPOSITION IS COMPARABLE WITH PROPOSALS. IF DISCREPANCIES BETWEEN DETAILS / CALCULATIONS MAY BE NECESSARY.
11. FOUNDATIONS TO BE CONCRETE OR SIMILAR ORIGINAL DISPOSITION IS COMPARABLE WITH PROPOSALS. IF DISCREPANCIES BETWEEN DETAILS / CALCULATIONS MAY BE NECESSARY.
12. FOUNDATIONS TO BE CONCRETE OR SIMILAR ORIGINAL DISPOSITION IS COMPARABLE WITH PROPOSALS. IF DISCREPANCIES BETWEEN DETAILS / CALCULATIONS MAY BE NECESSARY.
13. FOUNDATIONS TO BE CONCRETE OR SIMILAR ORIGINAL DISPOSITION IS COMPARABLE WITH PROPOSALS. IF DISCREPANCIES BETWEEN DETAILS / CALCULATIONS MAY BE NECESSARY.
14. FOUNDATIONS TO BE CONCRETE OR SIMILAR ORIGINAL DISPOSITION IS COMPARABLE WITH PROPOSALS. IF DISCREPANCIES BETWEEN DETAILS / CALCULATIONS MAY BE NECESSARY.
15. FOUNDATIONS TO BE CONCRETE OR SIMILAR ORIGINAL DISPOSITION IS COMPARABLE WITH PROPOSALS. IF DISCREPANCIES BETWEEN DETAILS / CALCULATIONS MAY BE NECESSARY.
16. FOUNDATIONS TO BE CONCRETE OR SIMILAR ORIGINAL DISPOSITION IS COMPARABLE WITH PROPOSALS. IF DISCREPANCIES BETWEEN DETAILS / CALCULATIONS MAY BE NECESSARY.
17. FOUNDATIONS TO BE CONCRETE OR SIMILAR ORIGINAL DISPOSITION IS COMPARABLE WITH PROPOSALS. IF DISCREPANCIES BETWEEN DETAILS / CALCULATIONS MAY BE NECESSARY.
18. FOUNDATIONS TO BE CONCRETE OR SIMILAR ORIGINAL DISPOSITION IS COMPARABLE WITH PROPOSALS. IF DISCREPANCIES BETWEEN DETAILS / CALCULATIONS MAY BE NECESSARY.
19. FOUNDATIONS TO BE CONCRETE OR SIMILAR ORIGINAL DISPOSITION IS COMPARABLE WITH PROPOSALS. IF DISCREPANCIES BETWEEN DETAILS / CALCULATIONS MAY BE NECESSARY.
20. FOUNDATIONS TO BE CONCRETE OR SIMILAR ORIGINAL DISPOSITION IS COMPARABLE WITH PROPOSALS. IF DISCREPANCIES BETWEEN DETAILS / CALCULATIONS MAY BE NECESSARY.
21. FOUNDATIONS TO BE CONCRETE OR SIMILAR ORIGINAL DISPOSITION IS COMPARABLE WITH PROPOSALS. IF DISCREPANCIES BETWEEN DETAILS / CALCULATIONS MAY BE NECESSARY.
22. FOUNDATIONS TO BE CONCRETE OR SIMILAR ORIGINAL DISPOSITION IS COMPARABLE WITH PROPOSALS. IF DISCREPANCIES BETWEEN DETAILS / CALCULATIONS MAY BE NECESSARY.
23. FOUNDATIONS TO BE CONCRETE OR SIMILAR ORIGINAL DISPOSITION IS COMPARABLE WITH PROPOSALS. IF DISCREPANCIES BETWEEN DETAILS / CALCULATIONS MAY BE NECESSARY.
24. FOUNDATIONS TO BE CONCRETE OR SIMILAR ORIGINAL DISPOSITION IS COMPARABLE WITH PROPOSALS. IF DISCREPANCIES BETWEEN DETAILS / CALCULATIONS MAY BE NECESSARY.
25. FOUNDATIONS TO BE CONCRETE OR SIMILAR ORIGINAL DISPOSITION IS COMPARABLE WITH PROPOSALS. IF DISCREPANCIES BETWEEN DETAILS / CALCULATIONS MAY BE NECESSARY.
26. FOUNDATIONS TO BE CONCRETE OR SIMILAR ORIGINAL DISPOSITION IS COMPARABLE WITH PROPOSALS. IF DISCREPANCIES BETWEEN DETAILS / CALCULATIONS MAY BE NECESSARY.
27. FOUNDATIONS TO BE CONCRETE OR SIMILAR ORIGINAL DISPOSITION IS COMPARABLE WITH PROPOSALS. IF DISCREPANCIES BETWEEN DETAILS / CALCULATIONS MAY BE NECESSARY.
28. FOUNDATIONS TO BE CONCRETE OR SIMILAR ORIGINAL DISPOSITION IS COMPARABLE WITH PROPOSALS. IF DISCREPANCIES BETWEEN DETAILS / CALCULATIONS MAY BE NECESSARY.
29. FOUNDATIONS TO BE CONCRETE OR SIMILAR ORIGINAL DISPOSITION IS COMPARABLE WITH PROPOSALS. IF DISCREPANCIES BETWEEN DETAILS / CALCULATIONS MAY BE NECESSARY.
30. FOUNDATIONS TO BE CONCRETE OR SIMILAR ORIGINAL DISPOSITION IS COMPARABLE WITH PROPOSALS. IF DISCREPANCIES BETWEEN DETAILS / CALCULATIONS MAY BE NECESSARY.
31. FOUNDATIONS TO BE CONCRETE OR SIMILAR ORIGINAL DISPOSITION IS COMPARABLE WITH PROPOSALS. IF DISCREPANCIES BETWEEN DETAILS / CALCULATIONS MAY BE NECESSARY.

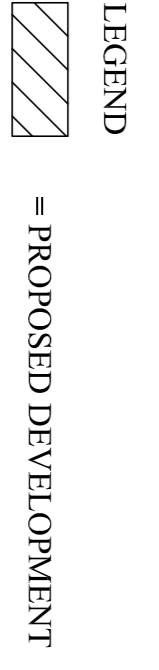
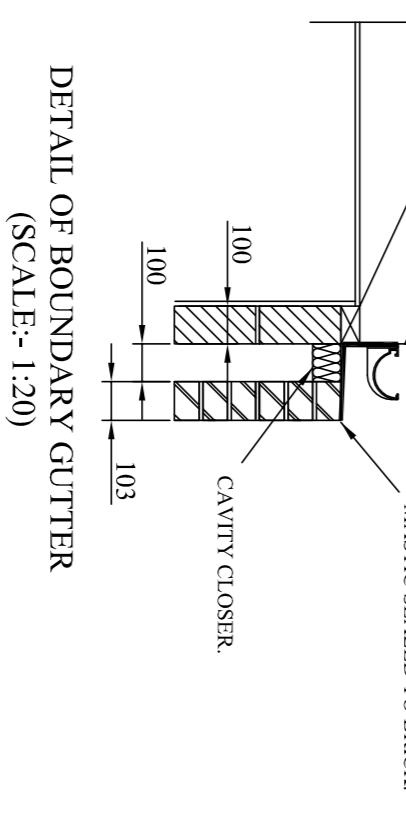
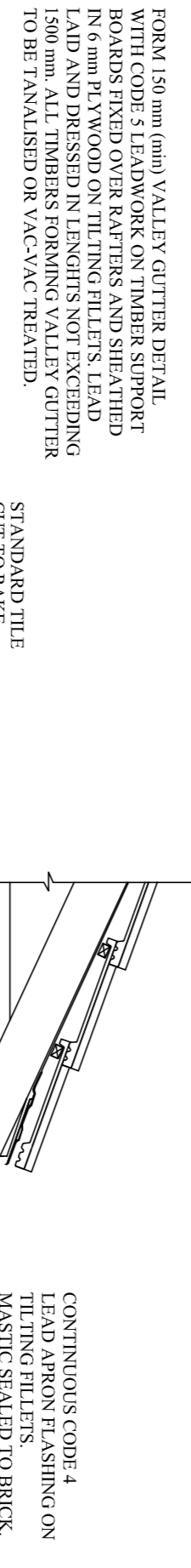

AD-15-61 - SHT. 1 - PROPOSED EXTENSION.  
AD-15-61 - SHT. 2 - EXISTING & PROPOSED SITE PLANS.

REV	SIG	DATE
1	AD	21/12/2015

FRONT PROJECTION  
REDUCED FROM 1500 mm  
TO 1400 mm.

DRAWING No. AD-15-61

CLIENT: MR & MRS MOORE

ADDRESS: 6 TIDESPRING ROW, HEEBURN, TYNE & WEAR, NE31 1AS

TITLE:  
PROPOSED EXTENSION

REV	DATE	SCALE	SHT	SIZE
1	OCT - 2015	1:100	1	A1

FOR DRAWINGS TEL:- 0191 4204980 or 07970670053

